

G06HI Die Cast Zinc Torque Hinge

Features

- Friction hinge allows panel, door or cover to be held in every position

Material

- Body: Die cast zinc, black powder coated
- Pin: Stainless steel 304

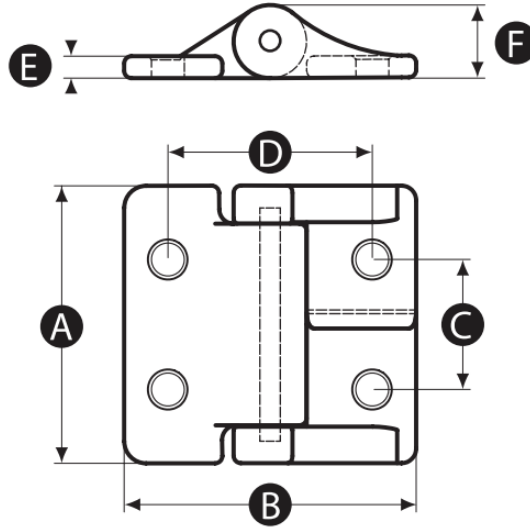

Part No.	A	B	C	D	E	F	Bore Size
G06HI-15744S	38	40	18	28	3	10	4.5

Part No.	Hinge Torque	Radial Load	Axial Load	Recommended Tightening Torque	Approx. Shear Force Per Screw
G06HI-15744S	0.4 N.m	1,100 N	2,100 N	1.5 N.m	0.28 kN